

Accessory 2-Bike Expansion Kit for Full Nelson & Three-Quarter Nelson Truck Mount Bicycle Carriers (carriers sold separately).

Rated for 70 lbs (35 lbs per Bicycle) of payload per SpinWing.

**PARTS**

QTY. DESCRIPTION

- 1 STEM
- 1 SPIN RING
- 1 SPIN PIN
- 1 1/2" WASHER
- 4 UPPER WHEEL CRADLE
- 4 LOWER WHEEL CRADLE
- 8 RUBBER STRAPS
- 2 WING
- 8 CRADLE HOUSING
- 8 RETAINER CLIP
- 2 RING PIN
- 1 72" CABLE (WITH LARGE LOOP)
- 1 LOCK & KEYS

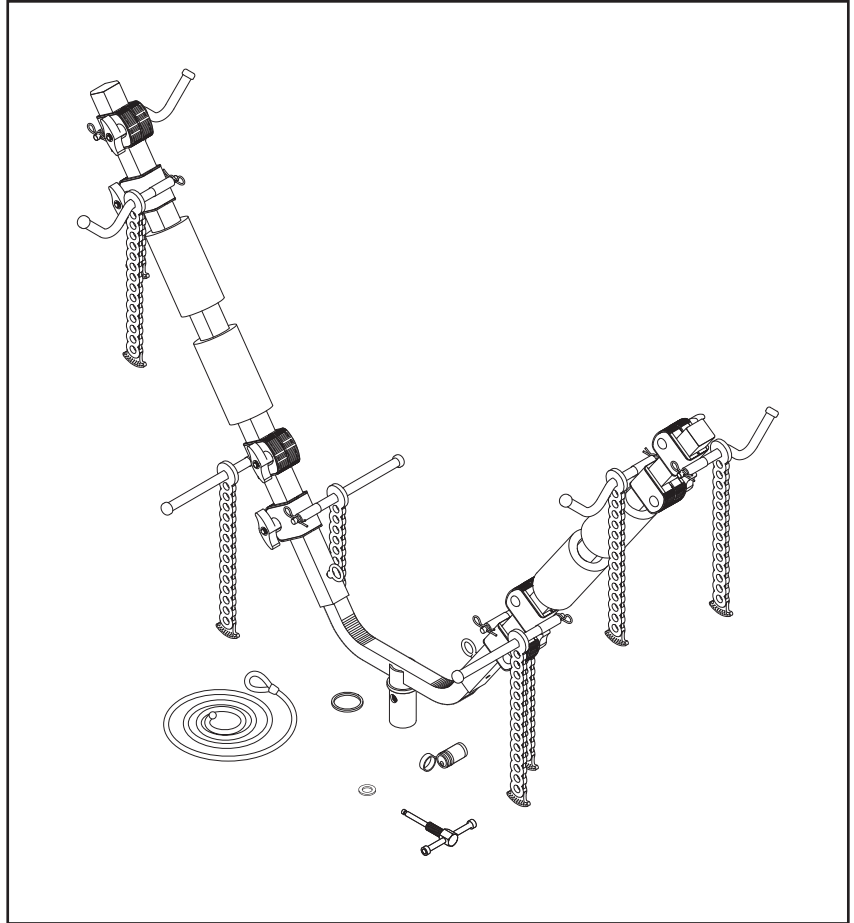

**Refer to your Full Nelson (Part no. B01809) or Three-Quarter Nelson (Part no. B01533) Manual for proper SpinWing installation and operation procedure.**

**NOTICE:** All Manual information is subject to change without notice. Revised editions will be available for free download at LetsGoAero.com. Manual information is considered factual until made obsolete by a revised version.

**Follow this QR-Code or visit LetsGoAero.com/manuals to check for an updated version:**



For Product Registration, or For More Product Information & Accessories,  
Visit our Website - [www.LetsGoAero.com](http://www.LetsGoAero.com)  
For Technical Support & Product Questions Contact Us at 877-464-2376 or 719- 630-3800  
Email: [SUPPORT@LETSGOAERO.COM](mailto:SUPPORT@LETSGOAERO.COM)

Patent and trademark protected:  
Patent Numbers 8,889,456; 14/546.993; Patents Pending

**⚠ IMPORTANT:**

Always be sure the carrier and the mounted bicycles are at least 6in from the cab of truck to avoid contact between the bicycles, carrier and the vehicle especially while loading and unloading bicycles and gear.

**⚠ WARNING:**

Always secure each bicycle with all four connections points (two Upper Wheel Cradles & two Lower Cradles). Do not operate the vehicle unless all connection points are tight and secured. Failure to follow bicycle mounting procedure may result in damage to carrier, damage to property, bodily injury or death.

**⚠ WARNING:**

Always check and confirm all truck mounting points are tight and fully secured before each transit. Failure to follow proper installation and equipment checks before transit may result in damage to carrier, damage to property, bodily injury or death.

**To register your product, visit the [LetsGoAero.com/registration](https://www.LetsGoAero.com/registration)**

**Technical Support**

For assistance with this product, please contact us:

Let's Go Aero, Inc.  
4474 Barnes Road  
Colorado Springs, CO 80917 USA  
Phone: 877-464-2376 or 719-630-3800  
Email: [Support@LetsGoAero.com](mailto:Support@LetsGoAero.com)

To learn more about our products and stay informed about useful options for transporting all kinds of gear with your carrier, be sure to visit our website: [www.LetsGoAero.com](http://www.LetsGoAero.com)

Patent and trademark protected:  
Patent Numbers 8,889,456; 14/546.993; Patents Pending

Copyright© 2019, Lets Go Aero, Inc., All rights reserved.