

(((*STOP THE NOISE!*)))™

5/8" Silent Hitch Pin®
Part No. SHP359

*Anti-Rattle Technology
For Hollow 2" Hitch Receivers*

Parts (preassembled):

Silent Hitch Pin (SHP)

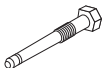

Split Washer



Spring Nut



Sleeve



Pin Clip



Engineered & Patented
by Let's Go Aero, Inc.
LetsGoAero.com | 877-464-2376
Colorado Springs, CO USA

US Patent Nos. 6,409,203; 6,609,725;
6,945,549; 8,079,613

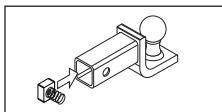

STEP 1:

Insert the Spring Nut into the hitch accessory shank tube (example ball mount shown). Align the Spring Nut's coil with the hitch receiver pin hole.

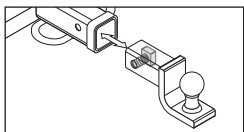

STEP 2:

With the Spring Nut compressed within the accessory shank, slide the shank into the vehicle's hitch receiver and align the hitch pin holes.

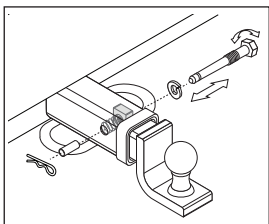

STEP 3:

Insert the Silent Hitch Pin with the Split Washer into the hitch pin hole and thread the pin through the threaded *block side* of the Spring Nut as shown. Slide the Sleeve over the end of the pin and into the receiver pin hole.

Using a **7/8" wrench**, fully tighten the Pin so it is snug and tight; secure with Clip. You are now ready for Safe & Silent Towing[®].